

Features

1 & 2 Pole relay range
46.52 - 2 Pole 8 A
46.61 - 1 Pole 16 A

- Socket mount or direct connection via Faston connectors
- AC coils & DC coils
- Available with: lockable test button, mechanical indicator & LED indicator
- 8 mm, 6 kV (1.2/50 μ s) isolation, coil-contacts
- Cadmium Free contacts

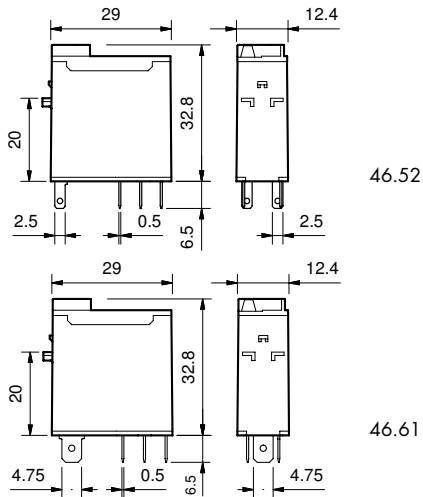

FOR UL HORSEPOWER AND PILOT DUTY RATINGS
 SEE "General technical information" page V

46.52



- 2 Pole CO, 8 A
- Plug-in/Solder terminals

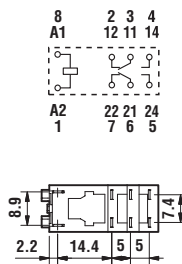

46.61



- 1 Pole CO, 16 A
- Plug-in/Faston 187

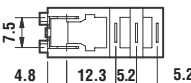
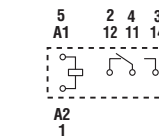

| Contact specification | | | |
|---|-----------------|--------------------------------------|--------------------------------------|
| Contact configuration | | 2 CO (DPDT) | 1 CO (SPDT) |
| Rated current/Maximum peak current | A | 8/15 | 16/25 |
| Rated voltage/Maximum switching voltage | V AC | 250/440 | 250/440 |
| Rated load AC1 | VA | 2,000 | 4,000 |
| Rated load AC15 (230 V AC) | VA | 350 | 750 |
| Single phase motor rating (230 V AC) | kW | 0.37 | 0.55 |
| Breaking capacity DC1: 30/110/220 V | A | 6/0.5/0.15 | 12/0.5/0.15 |
| Minimum switching load | mW (V/mA) | 300 (5/5) | 300 (5/5) |
| Standard contact material | | AgNi | AgNi |
| Coil specification | | | |
| Nominal voltage (U _N) | V AC (50/60 Hz) | 12 - 24 - 48 - 110 - 120 - 230 - 240 | |
| | V DC | 12 - 24 - 48 - 110 - 125 | |
| Rated power | VA/W | 1.2/0.5 | 1.2/0.5 |
| Operating range | AC | (0.8...1.1)U _N | (0.8...1.1)U _N |
| | DC | (0.73...1.1)U _N | (0.73...1.1)U _N |
| Holding voltage | AC/DC | 0.8U _N /0.4U _N | 0.8U _N /0.4U _N |
| Must drop-out voltage | AC/DC | 0.2U _N /0.1U _N | 0.2U _N /0.1U _N |
| Technical data | | | |
| Mechanical life AC/DC | cycles | 10 · 10 ⁶ | 10 · 10 ⁶ |
| Electrical life at rated load AC1 | cycles | 100 · 10 ³ | 100 · 10 ³ |
| Operate/release time | ms | 10/3 | 15/5 |
| Insulation between coil and contacts (1.2/50 μ s) | kV | 6 (8 mm) | 6 (8 mm) |
| Dielectric strength between open contacts | V AC | 1,000 | 1,000 |
| Ambient temperature range | °C | -40 ... +70 | -40 ... +70 |
| Environmental protection | | RT II | RT II |
| Approvals (according to type) | | | |

Ordering information

Example: 46 series Miniature industrial relay, 1 CO (SPDT), 24 V DC coil, lockable test button and mechanical indicator.

| | | | | | | | | | | | | |
|---|--|----------|----------|----------|----------|----------|----------|----------|----------|----------|----------|----------|
| | 4 | 6 | 6 | 1 | 9 | 0 | 2 | 4 | 0 | 0 | 4 | 0 |
| | | | | | | | | | A | B | C | D |
| Series | | | | | | | | | | | | |
| Type | | | | | | | | | | | | |
| 5 = Spade/blade solder terminal (2.5x0.5)mm | | | | | | | | | | | | |
| 6 = Spade/blade terminal Faston 187 (4.8x0.5)mm | | | | | | | | | | | | |
| No. of poles | | | | | | | | | | | | |
| 1 = 1 pole, 16 A | | | | | | | | | | | | |
| 2 = 2 poles, 8 A | | | | | | | | | | | | |
| Coil version | | | | | | | | | | | | |
| 9 = DC | | | | | | | | | | | | |
| 8 = AC (50/60 Hz) | | | | | | | | | | | | |
| Coil voltage | | | | | | | | | | | | |
| See coil specifications | | | | | | | | | | | | |
| | <p>A: Contact material 0 = AgNi 4 = AgSnO₂ (46.61 only) 5 = AgNi + Au (5 μm)</p> <p>B: Contact circuit 0 = CO (nPDT)</p> <p>D: Special versions 0 = Standard</p> <p>C: Options 2 = Mechanical indicator 4 = Lockable test button + mechanical indicator 54 = Lockable test button + LED (AC) + mechanical indicator 74 = Lockable test button + double LED (DC non-polarized) + mechanical indicator</p> | | | | | | | | | | | |

Selecting features and options: only combinations in the same row are possible.
 Preferred selections for best availability are shown in **bold**.

| Type | Coil version | A | B | C | D |
|-------|--------------|------------------|----------|--------------|----------|
| 46.52 | AC - DC | 0 - 5 | 0 | 2 - 4 | 0 |
| | AC | 0 - 5 | 0 | 54 | / |
| | DC | 0 - 5 | 0 | 74 | / |
| 46.61 | AC - DC | 0 - 4 - 5 | 0 | 2 - 4 | 0 |
| | AC | 0 - 4 - 5 | 0 | 54 | / |
| | DC | 0 - 4 - 5 | 0 | 74 | / |

Descriptions: Options

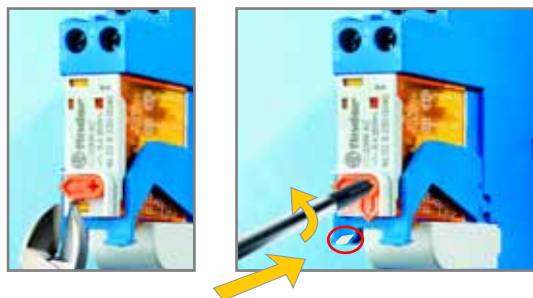
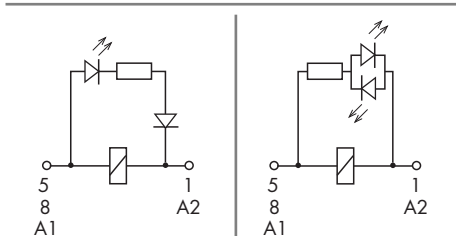

Lockable test button and mechanical flag indicator (0040, 0054, 0074)

The dual-purpose Finder test button can be used in two ways:

Case 1) The plastic pip (located directly below the test button) remains intact. In this case, when the test button is pushed, the contacts operate. When the test button is released the contacts return to their former state.

Case 2) The plastic pip is broken-off (using an appropriate cutting tool). In this case, (in addition to the above function), when the test button is pushed and rotated, the contacts are latched in the operating state, and remain so until the test button is rotated back to its former position.

In both cases ensure that the test button actuation is swift and decisive.

Technical data

| Insulation according to EN 61810-1:2004 | | | | |
|--|-------------------------|---------------------|-------|---------------------|
| | | 1 pole | | 2 pole |
| Nominal voltage of supply system | V AC | 230/400 | | 230/400 |
| Rated insulation voltage | V AC | 250 | 400 | 250 400 |
| Pollution degree | | 3 | 2 | 3 2 |
| Insulation between coil and contact set | | | | |
| Type of insulation | | Reinforced (8 mm) | | Reinforced (8 mm) |
| Overvoltage category | | III | | III |
| Rated impulse voltage | kV (1.2/50 μs) | 6 | | 6 |
| Dielectric strength | V AC | 4,000 | | 4,000 |
| Insulation between adjacent contacts | | | | |
| Type of insulation | | — | | Basic |
| Overvoltage category | | — | | III |
| Rated impulse voltage | kV (1.2/50 μs) | — | | 4 |
| Dielectric strength | V AC | — | | 2,000 |
| Insulation between open contacts | | | | |
| Type of disconnection | | Micro-disconnection | | Micro-disconnection |
| Dielectric strength | V AC/kV (1.2/50 μs) | 1,000/1.5 | | 1,000/1.5 |
| Conducted disturbance immunity | | | | |
| Burst (5...50)ns, 5 kHz, on A1 - A2 | | EN 61000-4-4 | | level 4 (4 kV) |
| Surge (1.2/50 μs) on A1 - A2 (differential mode) | | EN 61000-4-5 | | level 3 (2 kV) |
| Other data | | 46.61 | | 46.52 |
| Bounce time: NO/NC | ms | 2/6 | | 1/4 |
| Vibration resistance (10...150)Hz: NO/NC | g | 20/12 | | 20/15 |
| Shock resistance | g | 20 | | 20 |
| Power lost to the environment | without contact current | W | 0.6 | |
| | with rated current | W | 1.6 2 | |

Contact specification

F 46 - Electrical life (AC) v contact current

Type 46.52

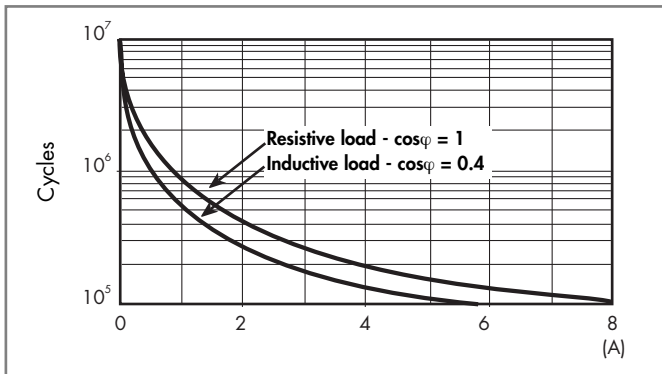
F 46 - Electrical life (AC) v contact current

Type 46.61

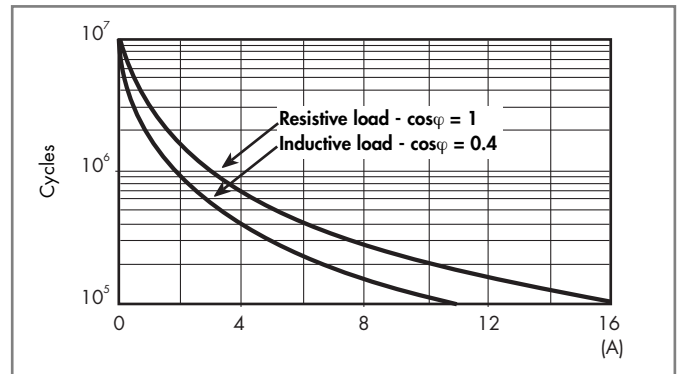
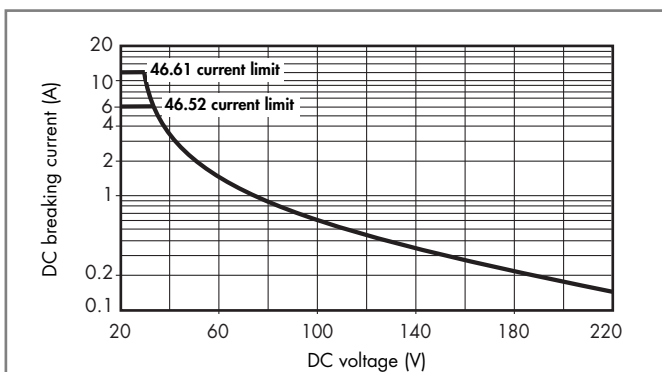
H 46 - Maximum DC1 breaking capacity

- When switching a resistive load (DC1) having voltage and current values under the curve, an electrical life of $\geq 100 \cdot 10^3$ can be expected.
- In the case of DC13 loads, the connection of a diode in parallel with the load will permit a similar electrical life as for a DC1 load.
Note: the release time for the load will be increased.

Coil specifications

DC coil data

| Nominal voltage U_N | Coil code | Operating range | | Resistance R | Rated coil consumption I at U_N |
|--------------------------|-----------|-----------------|-----------|-------------------|--|
| | | U_{min} | U_{max} | | |
| V | | V | V | Ω | mA |
| 12 | 9.012 | 8.8 | 13.2 | 300 | 40 |
| 24 | 9.024 | 17.5 | 26.4 | 1,200 | 20 |
| 48 | 9.048 | 35 | 52.8 | 4,800 | 10 |
| 110 | 9.110 | 80 | 121 | 23,500 | 4.7 |
| 125 | 9.125 | 91.2 | 137.5 | 32,000 | 3.9 |

AC coil data

| Nominal voltage U_N | Coil code | Operating range | | Resistance R | Rated coil consumption I at U_N |
|--------------------------|-----------|-----------------|-----------|-------------------|--|
| | | U_{min} | U_{max} | | |
| V | | V | V | Ω | mA |
| 12 | 8.012 | 9.6 | 13.2 | 80 | 90 |
| 24 | 8.024 | 19.2 | 26.4 | 320 | 45 |
| 48 | 8.048 | 38.4 | 52.8 | 1,350 | 21 |
| 110 | 8.110 | 88 | 121 | 6,900 | 9.4 |
| 120 | 8.120 | 96 | 132 | 9,000 | 8.4 |
| 230 | 8.230 | 184 | 253 | 28,000 | 5 |
| 240 | 8.240 | 192 | 264 | 31,500 | 4.1 |

R 46 - DC coil operating range v ambient temperature

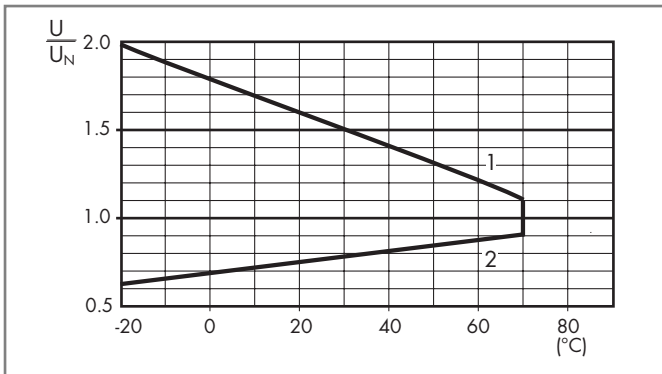

- 1 - Max. permitted coil voltage.
2 - Min. pick-up voltage with coil at ambient temperature.

R 46 - AC coil operating range v ambient temperature

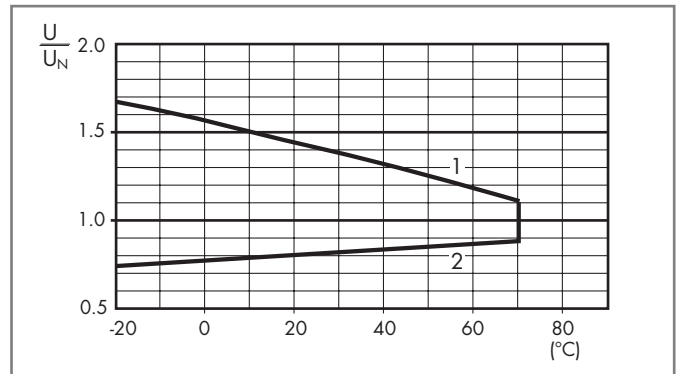

- 1 - Max. permitted coil voltage.
2 - Min. pick-up voltage with coil at ambient temperature.

Accessories



046.05



046.05 with relay

Flange mount adaptor for relays types 46.52 and 46.61

046.05

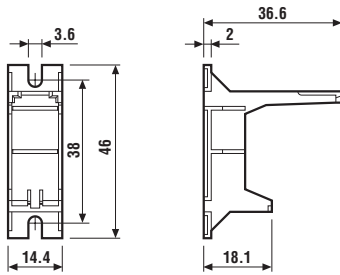

046.05

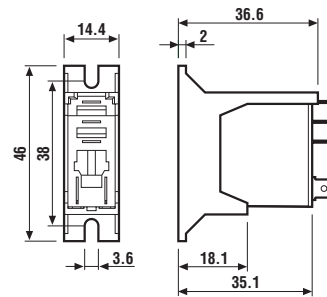

046.05 with relay



046.07



046.07 with relay

35 mm rail adaptor for relays types 46.52 and 46.61

046.07

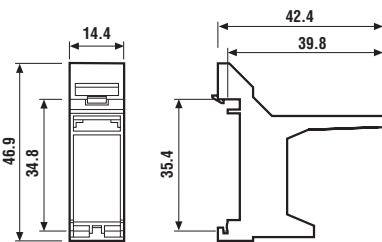

046.07

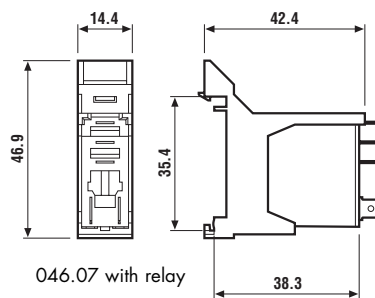

046.07 with relay

Sheet of marker tags for relays types 46.52 and 46.61 (72 tags), 6x12mm

060.72



060.72



97.01

Approvals
(according to type):



097.01

| | | | | |
|--|--|------------------------|---------------------|------------------------|
| Screw terminal socket panel or 35 mm rail (EN 50022) mount | 97.01 (blue) | 97.01.0 (black) | 97.02 (blue) | 97.02.0 (black) |
| For relay type | 46.61 | | 46.52 | |
| Accessories | | | | |
| Plastic retain and release clip (supplied with socket - packaging code SPA) | | | 097.01 | |
| Identification tag | | | 095.00.4 | |
| 8-way jumper link | 095.18 (blue) | | 095.18.0 (black) | |
| Modules (see table below) | | | 99.02 | |
| Timer modules (see table below) | | | 86.30 | |
| Technical data | | | | |
| Rated current | 16 A - 250 V AC | | 8 A - 250 V AC | |
| Dielectric strength | 6 kV (1.2/50 μs) between coil and contacts | | | |
| Protection category | IP 20 | | | |
| Ambient temperature | °C -40...+70 (see diagram L97) | | | |
| ⊕ Screw torque | Nm | 0.8 | | |
| Wire strip length | mm | 8 | | |
| Max. wire size for 97.01 and 97.02 sockets | solid wire | | stranded wire | |
| | mm ² | 1x6 / 2x2.5 | 1x4 / 2x2.5 | |
| | AWG | 1x10 / 2x14 | 1x12 / 2x14 | |

L 97 - Rated current vs ambient temperature
(for 46.61 relay / 97.01 socket combination)

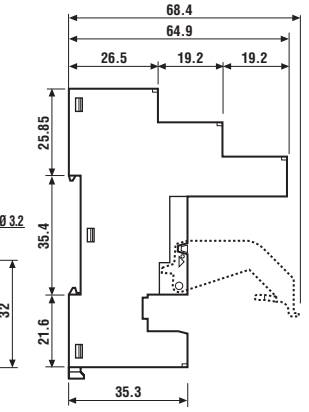
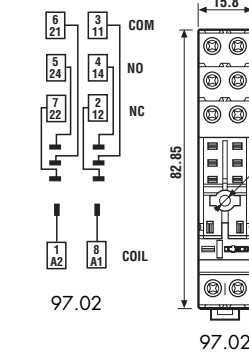
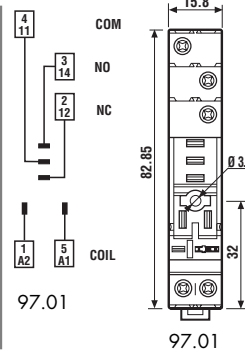
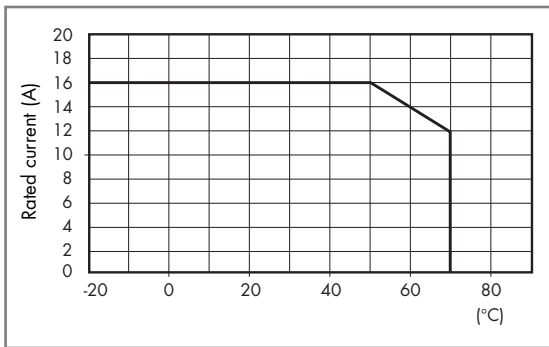

095.18

| | | |
|--|----------------------|-------------------------|
| 8-way jumper link for 97.01 and 97.02 sockets | 095.18 (blue) | 095.18.0 (black) |
| Rated values | 10 A - 250 V | |

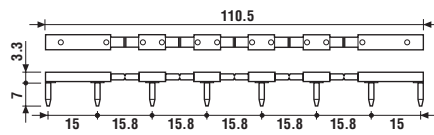

86.30

| | | |
|---|------------------|--|
| 86 series timer module | | |
| (12...24)V AC/DC; Bi-function: AI, DI; (0.05s...100h) | 86.30.0.024.0000 | |
| (230...240)V AC; Bi-function: AI, DI; (0.05s...100h) | 86.30.8.240.0000 | |

Approvals
(according to type):



99.02

Approvals
(according to type):



| | | |
|--|--------------------|----------------|
| 99.02 coil indication and EMC suppression modules for 97.01 and 97.02 sockets | | |
| Diode (+A1, standard polarity) | (6...220)V DC | 99.02.3.000.00 |
| LED | (6...24)V DC/AC | 99.02.0.024.59 |
| LED | (28...60)V DC/AC | 99.02.0.060.59 |
| LED | (110...240)V DC/AC | 99.02.0.230.59 |
| LED + Diode (+A1, standard polarity) | (6...24)V DC | 99.02.9.024.99 |
| LED + Diode (+A1, standard polarity) | (28...60)V DC | 99.02.9.060.99 |
| LED + Diode (+A1, standard polarity) | (110...220)V DC | 99.02.9.220.99 |
| LED + Varistor | (6...24)V DC/AC | 99.02.0.024.98 |
| LED + Varistor | (28...60)V DC/AC | 99.02.0.060.98 |
| LED + Varistor | (110...240)V DC/AC | 99.02.0.230.98 |
| RC circuit | (6...24)V DC/AC | 99.02.0.024.09 |
| RC circuit | (28...60)V DC/AC | 99.02.0.060.09 |
| RC circuit | (110...240)V DC/AC | 99.02.0.230.09 |
| Residual current by-pass | (110...240)V AC | 99.02.8.230.07 |

DC Modules with non-standard polarity (+A2) on request.

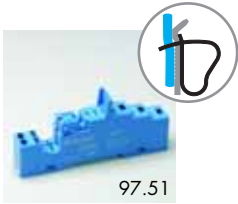

Approvals (according to type):



| | | | | |
|---|--|------------------------|---------------------|------------------------|
| Screwless terminal socket panel or 35 mm rail (EN 50022) mount | 97.51 (blue) | 97.51.0 (black) | 97.52 (blue) | 97.52.0 (black) |
| For relay type | 46.61 | | 46.52 | |
| Accessories | | | | |
| Plastic retain and release clip (supplied with socket - packaging code SPA) | | | 097.01 | |
| Modules (see table below) | | | 99.02 | |
| Timer modules (see table below) | | | 86.30 | |
| Technical data | | | | |
| Rated current | 10 A - 250 V AC | | 8 A - 250 V AC | |
| Dielectric strength | 6 kV (1.2/50 μs) between coil and contacts | | | |
| Protection category | IP 20 | | | |
| Ambient temperature | °C | -25...+70 | | |
| Wire strip length | mm | 8 | | |
| Max. wire size for 97.51 and 97.52 sockets | solid wire | stranded wire | | |
| | mm ² | 2x(0.2...1.5) | | 2x(0.2...1.5) |
| | AWG | 2x(24...18) | | 2x(24...18) |

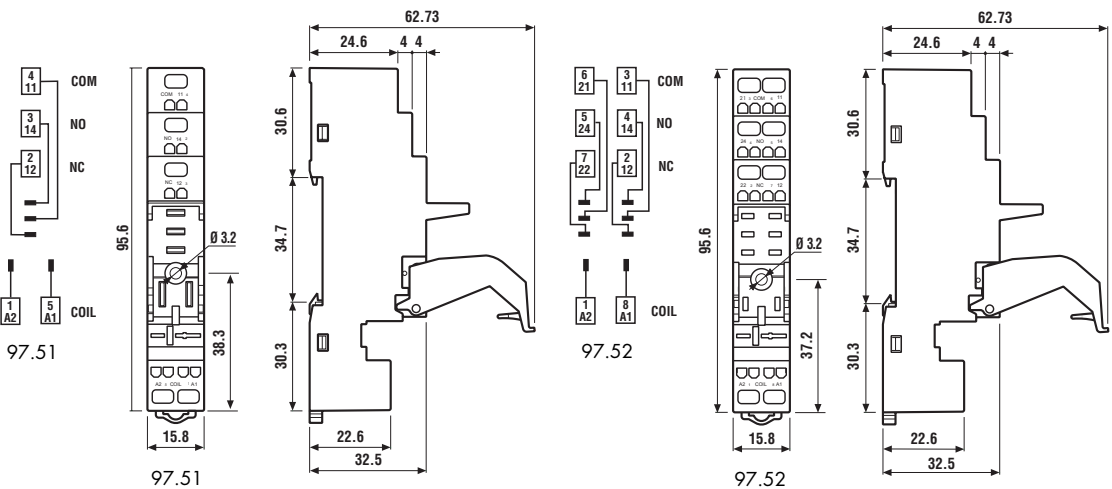
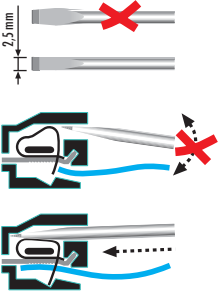

| | |
|---|------------------|
| 86 series timer module | |
| (12...24)V AC/DC; Bi-function: AI, DI; (0.05s...100h) | 86.30.0.024.0000 |
| (230...240)V AC; Bi-function: AI, DI; (0.05s...100h) | 86.30.8.240.0000 |

Approvals (according to type):



Approvals (according to type):



| | | | | |
|--|--------------------|----------------|--|--|
| 99.02 coil indication and EMC suppression modules for 97.51 and 97.52 sockets | | | | |
| Diode (+A1, standard polarity) | (6...220)V DC | 99.02.3.000.00 | | |
| LED | (6...24)V DC/AC | 99.02.0.024.59 | | |
| LED | (28...60)V DC/AC | 99.02.0.060.59 | | |
| LED | (110...240)V DC/AC | 99.02.0.230.59 | | |
| LED + Diode (+A1, standard polarity) | (6...24)V DC | 99.02.9.024.99 | | |
| LED + Diode (+A1, standard polarity) | (28...60)V DC | 99.02.9.060.99 | | |
| LED + Diode (+A1, standard polarity) | (110...220)V DC | 99.02.9.220.99 | | |
| LED + Varistor | (6...24)V DC/AC | 99.02.0.024.98 | | |
| LED + Varistor | (28...60)V DC/AC | 99.02.0.060.98 | | |
| LED + Varistor | (110...240)V DC/AC | 99.02.0.230.98 | | |
| RC circuit | (6...24)V DC/AC | 99.02.0.024.09 | | |
| RC circuit | (28...60)V DC/AC | 99.02.0.060.09 | | |
| RC circuit | (110...240)V DC/AC | 99.02.0.230.09 | | |
| Residual current by-pass | (110...240)V AC | 99.02.8.230.07 | | |

DC Modules with non-standard polarity (+A2) on request.

Packaging codes

How to code and identify retaining clip and packaging options for sockets. Example:

